



OLITUBE TRANSFORMER PRODUCTS

Insulation Products for Transformers



DIN 46235 Cable Lugs

E-Cu, tin plated.
(Available with inspection hole and as non-plated)

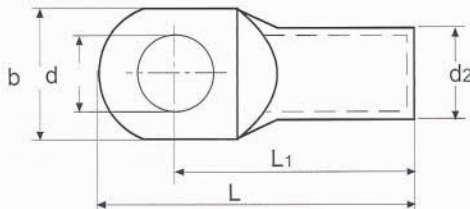
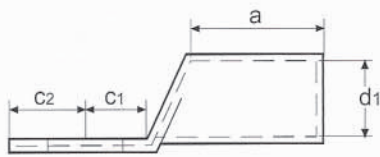
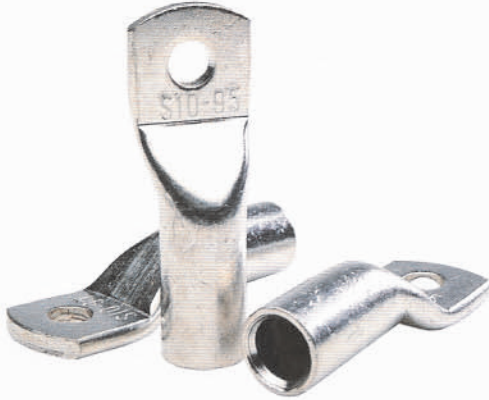

Highlighted bolts are standard production.

Cross Section mm ²	Bolt	Dimensions (mm)										1000 pcs - kg.	Pcs. per Box	Order No	
		d	d1	d2	L	L1	a	b	c1	c2					
6	M5	5.3			30.5				6.5	7.5			2.9	500	SKP-D2-00605 SKP-D2-00606 SKP-D2-00608
	M6	6.4	3.8	5.5	31.5	24	10	8.5	7.5	8					
	M8	8.4			34				13	10	10				
10	M5	5.3			34				7	8.5			3.2	400	SKP-D2-01005 SKP-D2-01006 SKP-D2-01008
	M6	6.4	4.5	6.0	34.5	27	10	9	7.5	8					
	M8	8.4			37				13	10	10				
16	M6	6.4			43.5				7.5	8			10.6	250	SKP-D2-01606 SKP-D2-01608 SKP-D2-01610 SKP-D2-01612
	M8	8.4	5.5	8.5	46	36	20	13	10	10					
	M10	10.5			48				17	12	12				
	M12	13			49				18	13	13				
25	M6	6.4			45.5				7.5	8			14.5	200	SKP-D2-02506 SKP-D2-02508 SKP-D2-02510 SKP-D2-02512
	M8	8.4	7	10	48	38	20	16	10	10					
	M10	10.5			50				17	12	12				
	M12	13			51				19	13	13				
35	M6	6.4			49.5				7.5	8			27.1	120	SKP-D2-03506 SKP-D2-03508 SKP-D2-03510 SKP-D2-03512 SKP-D2-03514
	M8	8.4	8.2	12.5	52	42	20	17	10	10					
	M10	10.5			54				19	12	12				
	M12	13			55				21	13	13				
	M14	15			56.5				21	14.5	14.5				
50	M8	8.4			62				10	10			40.2	65	SKP-D2-05008 SKP-D2-05010 SKP-D2-05012 SKP-D2-05014 SKP-D2-05016
	M10	10.5	10	14.5	64	52	28	22	12	12					
	M12	13			65				24	13	13				
	M14	15			66.5				24	14.5	14.5				
	M16	17			68				28	16	16				
70	M8	8.4			65				10	10			58.3	50	SKP-D2-07008 SKP-D2-07010 SKP-D2-07012 SKP-D2-07014 SKP-D2-07016
	M10	10.5	11.5	16.5	67	55	28	24	12	12					
	M12	13			68				24	13	13				
	M14	15			69.5				24	14.5	14.5				
	M16	17			71				30	16	16				
95	M8	8.4			77				12	12			79.2	30	SKP-D2-09508 SKP-D2-09510 SKP-D2-09512 SKP-D2-09514 SKP-D2-09516
	M10	10.5	13.5	19	78	65	35	28	13	13					
	M12	13			79.5				28	14.5	14.5				
	M14	15			81				32	16	16				
	M16	17			85				32	16	16				
120	M10	10.5			85				15	16			97.7	30	SKP-D2-12010 SKP-D2-12012 SKP-D2-12014 SKP-D2-12016 SKP-D2-12020
	M12	13	15.5	21	86	70	35	32	16	17					
	M14	15			88				18	19					
	M16	17			89				19	20					
	M20	21			91				38	21	22				
150	M10	10.5			93				15	16			145.5	25	SKP-D2-15010 SKP-D2-15012 SKP-D2-15014 SKP-D2-15016 SKP-D2-15020
	M12	13	17	23.5	94	78	35	34	16	17					
	M14	15			97				19	20					
	M16	17			97				19	20					
	M20	21			99				40	21	22				
185	M10	10.5			97				15	16			159.9	18	SKP-D2-18510 SKP-D2-18512 SKP-D2-18514 SKP-D2-18516 SKP-D2-18520
	M12	13	19	25.5	98	82	40	37	16	17					
	M14	15			101				19	20					
	M16	17			101				19	20					
	M20	21			103				40	21	22				
240	M12	13			108				16	17			232.3	12	SKP-D2-24012 SKP-D2-24014 SKP-D2-24016 SKP-D2-24020
	M14	15	21.5	29	111	92	40	42	19	20					
	M16	17			111				19	20					
	M20	21			113				45	21	22				
300	M14	15			119				19	22			285.6	12	SKP-D2-30014 SKP-D2-30016 SKP-D2-30020
	M16	17	24.5	32	119	100	50	48	19	22					
	M20	21			122				22						
400	M14	15			140				25	25			577	10	SKP-D2-40014 SKP-D2-40016 SKP-D2-40020
	M16	17	27.5	38.5	140	115	70	55	25	25					
	M20	21			140				25	25					
500	M16	17	31	42	150	125	70	60	25	25			683.8	10	SKP-D2-50016 SKP-D2-50020
	M20	21			150				25	25					
625	M16	17	34.5	44	160	135	80	64	25	25			679	10	SKP-D2-62516 SKP-D2-62520
	M20	21			160				25	25					
800	M16	17	40	52	195	165	100	75	30	30			1217.7	10	SKP-D2-80016 SKP-D2-80020
	M20	21			195				30	30					
1000	M16	17	44	58	195	165	100	85	30	30			1575.1	10	SKP-D2-100016 SKP-D2-100020
	M20	21			195				30	30					